

# CITY OF WINCHESTER TRUST

## Future 50



Date: 12/05/19

Author: Kathy Edwards

Location: Church of St John The Baptist, St John's Street



Church of St John The Baptist, view from North of St John's Street



Church of St John The Baptist, view from North of St John's Street 2





Church of St John The Baptist, view from South of St John's Street



Church of St John The Baptist, view from Blue Ball Hill





Church of St John The Baptist, view showing new trees from St John's Street





Church of St John The Baptist, main door





Church of St John The Baptist, exterior statue in niche





Church of St John The Baptist, exterior window





Church of St John The Baptist, view towards City



Church of St John The Baptist, weather vane



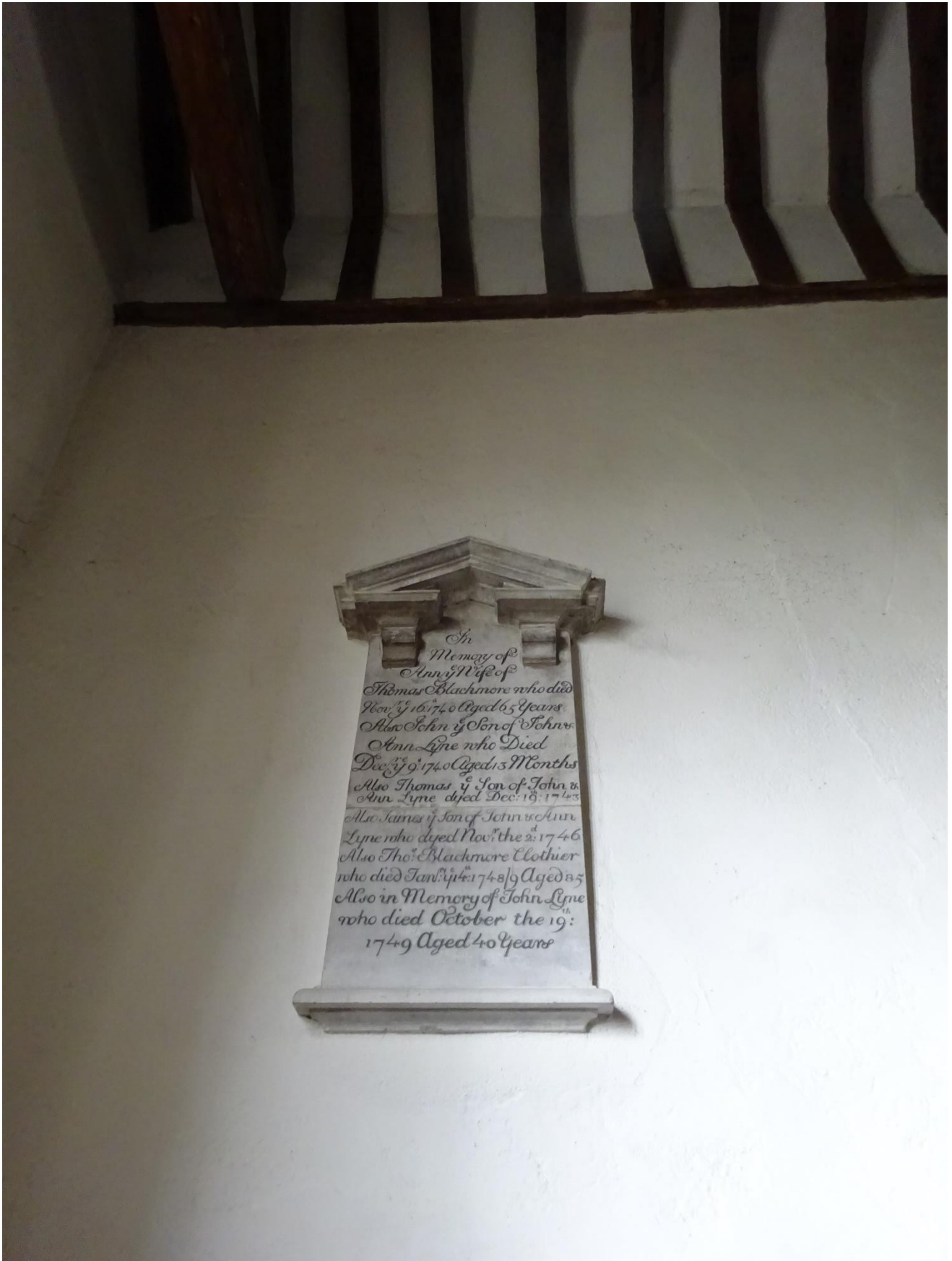

Church of St John The Baptist, Blackmore & Lynne Memorial 1700's

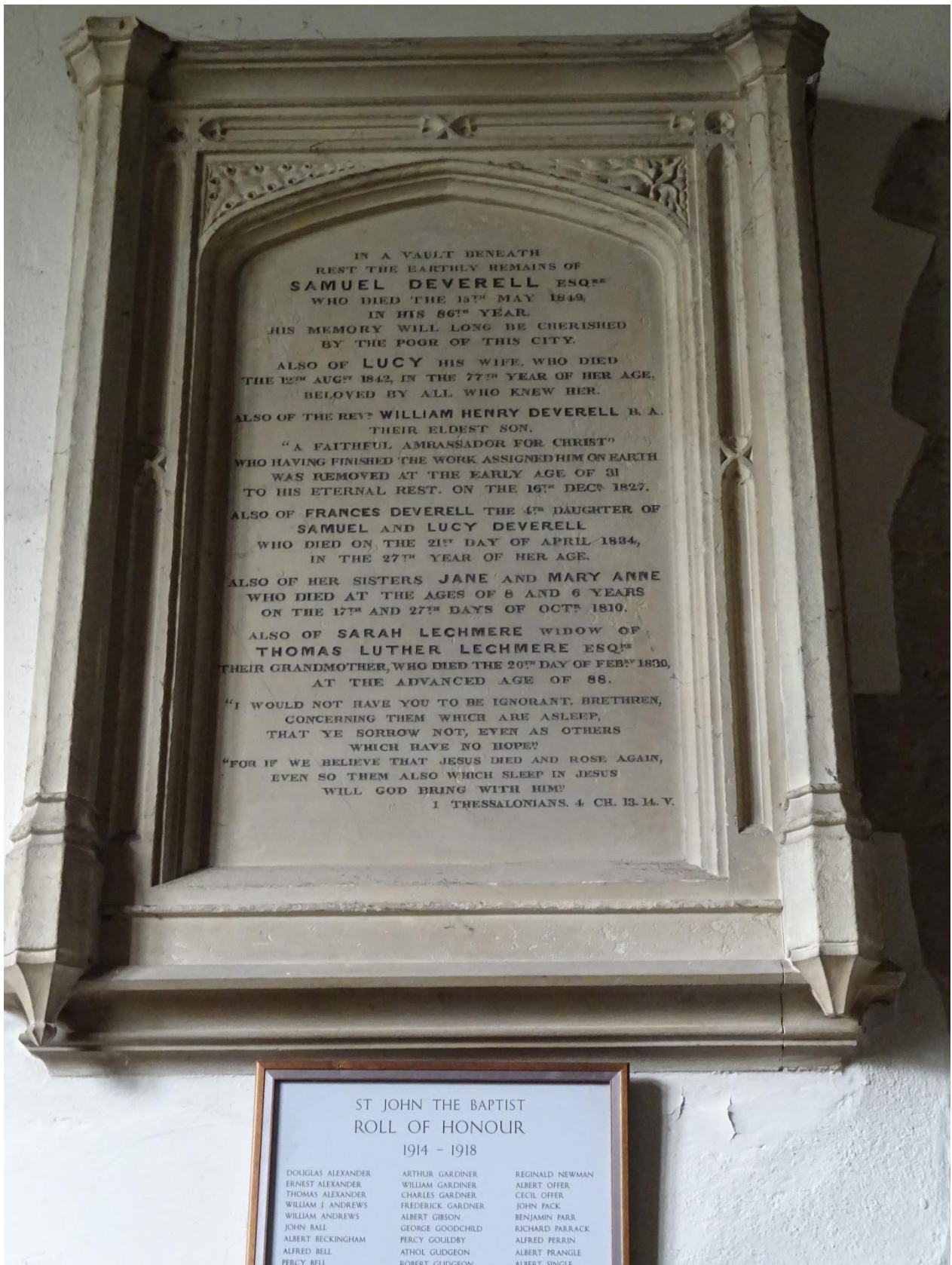

Church of St John The Baptist, Deverell Plaque





Church of St John The Baptist, Font and Window



Church of St John The Baptist, Fresco Niche, High Level





Church of St John The Baptist, Fresco Niche

ST JOHN THE BAPTIST  
ROLL OF HONOUR

1914 - 1918

DOUGLAS ALEXANDER  
ERNEST ALEXANDER  
THOMAS ALEXANDER  
WILLIAM J. ANDREWS  
WILLIAM ANDREWS  
JOHN BALL  
ALBERT BECKINGHAM  
ALFRED BELL  
PERCY BELL  
FREDERICK BISHOP  
ARCHIE BLANDFORD  
WILLIAM BRIGHT  
ALBERT BROOKS  
WILLIAM BROWNING  
GEORGE CARTER  
GERALD CASSIDY  
JAMES COBB  
ERNEST CROSS  
FRANCIS DAVIS  
DOUGLAS DEAR  
JOHN DUFFIN  
WILLIAM DUFFIN  
FREDERICK ELKINS  
FREDERICK ELKINS  
HERBERT ELKINS  
ARTHUR EYLES  
WILLIAM FACEY

ARTHUR GARDINER  
WILLIAM GARDINER  
CHARLES GARDNER  
FREDERICK GARDNER  
ALBERT GIBSON  
GEORGE GOODCHILD  
PERCY GOULDBY  
ATHOL GUDGEON  
ROBERT GUDGEON  
CHARLES HAINES  
WILLIAM HATT  
GEORGE HEWLETT  
ERNEST JUDD  
THOMAS JUDD  
WALTER LANGRIDGE  
WILLIAM LANSLEY  
REGINALD LUCAS  
ALBERT MARINER  
SIDNEY MARTIN  
THOMAS MARTIN  
WILLIAM MARTIN  
EDWIN MEACHER  
WILLIAM MILES  
ARTHUR MILLER  
REUBEN MILLS  
CHARLES MORRIS  
JOHN MOULD  
ARTHUR NEWMAN

REGINALD NEWMAN  
ALBERT OFFER  
CECIL OFFER  
JOHN PACK  
BENJAMIN PARR  
RICHARD PARRACK  
ALFRED PERRIN  
ALBERT PRANGLE  
ALBERT SINGLE  
ALFRED SMITH  
CHARLES SMITH  
FREDERICK SMITH  
ALBERT SPENCER  
JOSEPH SPENCER  
TOM STAINER  
JOHN STANLEY  
WALTER STEELE  
ALFRED STRIPP  
DENNIS SWAYNE  
CHARLES TOLLMAN  
THOMAS TOLLMAN  
GEORGE WARD  
THOMAS WARD  
WILLIAM WARD  
ALFRED WEBB  
EDWIN WILLIS  
WILLIAM WRIGHT

1939 - 1945

CHARLES ALNER  
LEROY ANGEL  
LESLIE CARTER  
WILLIAM CHEVIS  
ALFRED COOK  
WILLIAM DRAKE

STANLEY EADES  
WILLIAM ELDRIDGE  
DOUGLAS FIELDER  
FRANCIS GEOGHEGAN  
RICHARD HILL  
ROY HALL

THOMAS HAMLYN  
STANLEY JOYCE  
DOUGLAS NEWMAN  
LEONARD MILLER  
HENRY WALL  
ERNEST WILD

'...IN HIS LOVE HE WILL GIVE YOU NEW LIFE...'

Church of St John The Baptist, Great War Roll of Honour



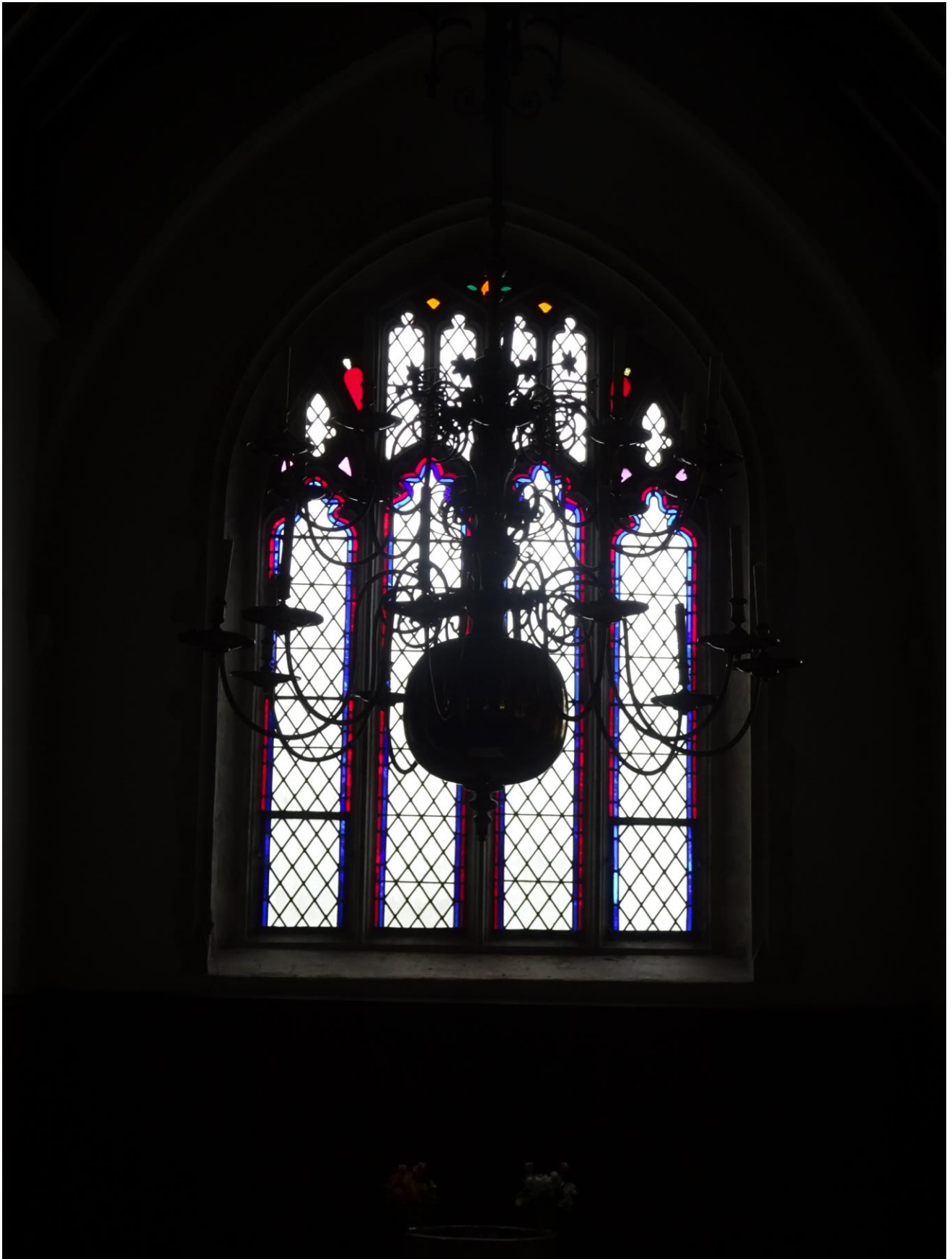

Church of St John The Baptist, Plain Window and Light





Church of St John The Baptist, Small Door





Church of St John The Baptist, Window 1





Church of St John The Baptist, Window 2





Church of St John The Baptist, Window 3





Church of St John The Baptist, Window 4

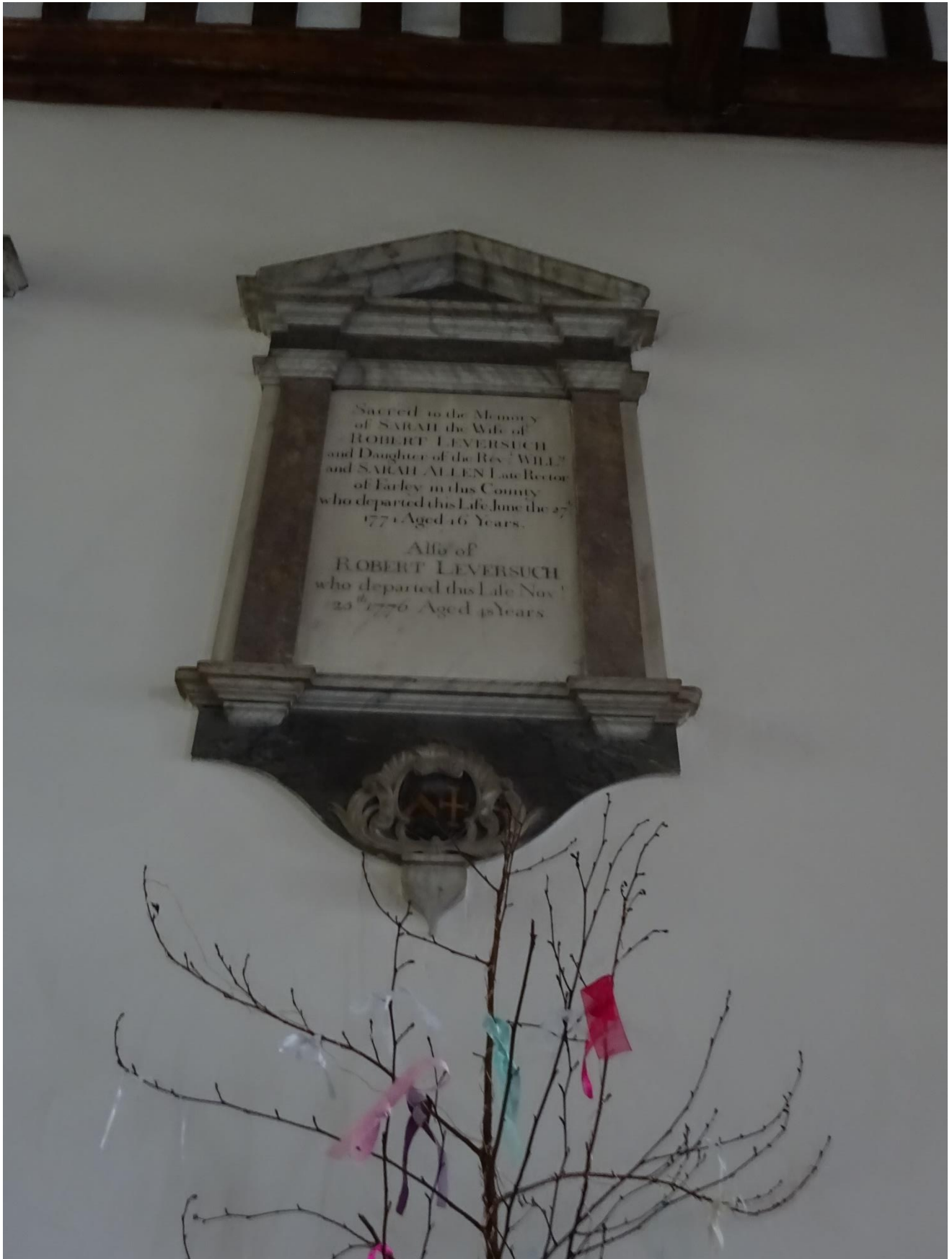

Church of St John The Baptist, J Leversuch 1771 Memorial Plaque





the walls safe on the upper side of the church



## Welcome to the Parish Church of St John the Baptist, Winchester



**I**n this small guide we hope to give you a brief glimpse of the treasures in our church. May you also experience during your stay something of its serenity - the outcome of over 800 years of Christian witness.

The Church has just undergone nearly half a million pound's worth of restoration work which has been funded by our own efforts and with the help of English Heritage, Winchester City Council and Hampshire County Council. The roof was completely refurbished and the interior has been reordered which involved the removal of the Victorian pews - some of these have been restored and placed in the Lady Chapel. For the first time in many hundreds of years the north door to the Church has been unblocked and reopened.

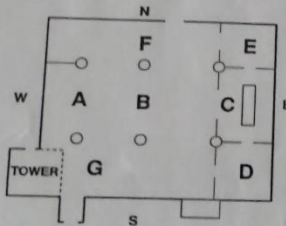

**How old is the church?** St John's is the oldest parish church in Winchester, but exactly how old remains elusive. It was certainly in existence in 1142. Even then, parts of it may have been older still as it stands in the middle of an important 4th century Romano-British cemetery.

### THE NAVE

**If you walk to Point A,** you will be in the oldest part of the church - the nave. Originally, the church would have consisted of a nave with narrow aisles either side. The round Norman pillars date from this time. In the late 12th century the aisles were widened to their present aspect, and the transitional arches included. Since the removal of the pews it is much easier to imagine the original medieval layout of the

church. Towards the end of your tour, at point F, you will be able to see evidence of this extension in the remains of a small Norman window in the west wall. The roof timbers date from the 15th century. Notice the impressive 18th century chandelier which as part of the restoration work has been repaired and cleaned.

### THE ROOD SCREEN AND PULPIT

**Move up the nave to Point B** in front of the tall 15th century oak rood screen. Above this rises the rood (the cross with the figure of Christ). Notice the mortises in the roof where the original rood was attached. At one time the screen would have had a rood loft (gallery) on top. Rood lofts were impressive structures, about 6 feet deep, made to accommodate the rood, perhaps singers and an organ, and from where the priest read the Gospel. They were ordered to be destroyed by an Elizabethan Act of 1561, but part of the rood loft passage can still be seen through the walls on both sides. This church is unusual because access to the rood loft is via an outside staircase housed in a turret on the south side.

**Walk in front of the rood screen northwards,** past the 15th century pulpit. Bishop Thomas Ken (1637-1711) the famous hymn writer, when he was a prebend at the Cathedral, frequently preached from here. In the south churchyard is a plaque commemorating the link between St John's and Winchester College, of which Thomas Ken had been a scholar and later a fellow. Just beyond, you will notice small openings cut low down in the solid part of the screen. These are 'elevation squints', cut so that children could see the uplifted Host during Mass. They are very rare and unique in Hampshire.

### THE CHANCEL

**Move back to the nave and climb the chancel steps to Point C.** To your right and left are the early 14th century parclose screens. In front rises the early 15th century east window. To the left of the window is a small niche in which a figure would have stood. You will see several more of these in the church and they offer us some insight into the church in earlier times. In the south wall of the sanctuary are a stone piscina (basin) and the remains of a sedilla (recessed seat) for the priest.

**At one time** there were three altars, one in each aisle. Squints set into the walls on either side of the central altar allowed the three celebrating priests to synchronise their movements.

### THE LADY CHAPEL

**Pass now to the south or Lady Chapel and Point D.** Look at the beautiful later 13th century window in the south wall. Its four lights with three bar-tracery circles is also unique in Hampshire. Unfortunately,

Church of St John The Baptist, History of the Church page 1



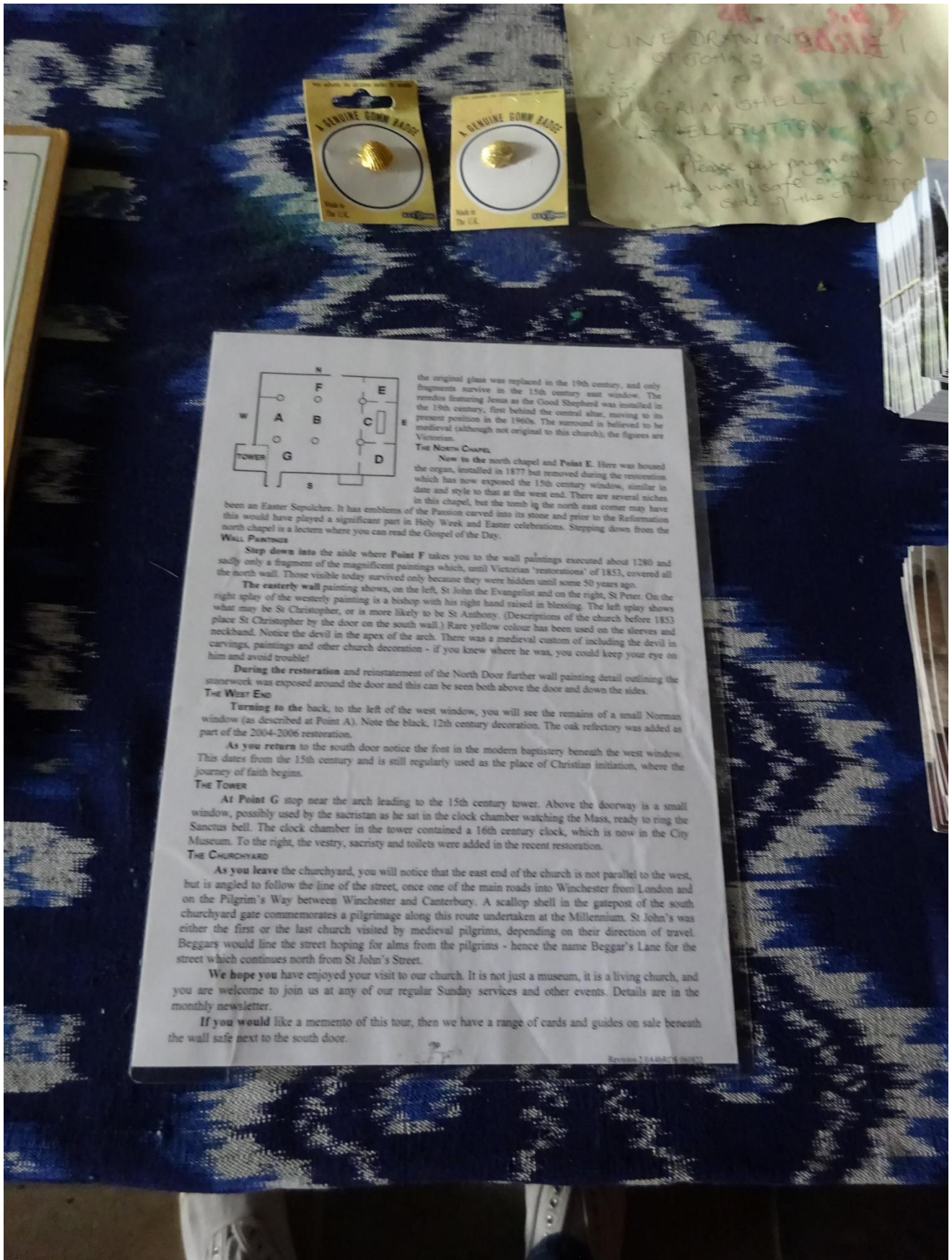

Church of St John The Baptist, History of the Church page 2





Church of St John The Baptist, Churchyard to the North of the Church





Church of St John The Baptist, Churchyard





Church of St John The Baptist, St John's Hall from Churchyard





Church of St John The Baptist, New Office





Church of St John The Baptist, Graves to the North of the Churchyard





Church of St John The Baptist, Notice Board





Church of St John The Baptist, Open Sign





Church of St John The Baptist, Pilgrim's Way Sign